

EVERGREEN

LEGEND

Residential Well Results

- 2009 or Ongoing 2016 Program Sampling Location with Equal to or an Exceedance of the Criteria (See Notes)
- 2009 or Ongoing 2016 Program Sampling Location with a Detection Below the Criteria (See Notes)
- 2009 or Ongoing 2016 Program Sampling Location with Concentrations Below the Limit of Detection (See Notes)

- Current Investigation Area
- Property Boundary
- Municipal Boundary

Notes:
 This is an Evergreen sampling location map and will be updated with sampling locations as they are sampled and results are finalized.
 Each well sampled is now identified by a Regulatory Location ID so that no private personal information (such as name and address) is provided here to maintain residential confidentiality. Table 1 provides the results for the samples analyzed for each potable well.

Limit of Detection as Indicated in Table 1.
 Reporting Limit for PFOA, PFOS, and PFNA is 0.002 µg/L.
 Criteria Applied (µg/L) for 2009 and 2016-2022:
 The NJDEP has a Drinking Water Standard for the following three PFAS:
 - PFOA is 0.014 µg/L;
 - PFOS is 0.013 µg/L; and
 - PFNA is 0.013 µg/L.
 For wells sampled more than once, the symbol color shown reflects the most recent sampling event results.

NJDEP = New Jersey Department of Environmental Protection
 PFOA = Perfluorooctanoic acid
 PFOS = Perfluorooctanesulfonic acid
 PFNA = Perfluorononanoic acid

Coordinates for sample locations obtained via GoogleMap, riparcels.com, NJ-Geoweb, and GIS.

2020 Maxar Aerial Source: Esri, DigitalGlobe, GeoEye, Earthstar Geographics, CNES/Airbus DS, USDA, USGS, AEX, Getmapping, Aerogrid, IGN, IGP, swisstopo, and the GIS User Community

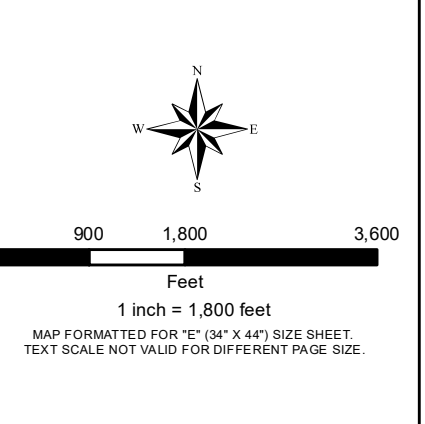

AECOM

AECOM
 245 Choptank Road
 Suite 101
 Newark, DE 19702

RESIDENTIAL POTABLE WELL SAMPLING LOCATIONS WITH RESULTS AS OF FEBRUARY 8, 2023

CHAMBERS WORKS COMPLEX
 DEERPATER, NEW JERSEY

ISSUE NUMBER: 23005
 PROJECT NUMBER: 60697560

DESIGNED BY: K. L. DAVIS
 DATE: 2/8/2023

DRAWN BY: C. DUFFY
 PROJECT NUMBER: 60697560

DATE PLOTTED: N. DEPOSE
 SHEET NUMBER: 1